

SAMPLE LANDSCAPING PLAN FOR SEVERAL LOCATIONS IN FRONT AND BACK

Key points to remember:

- * A complete landscaping plan must be presented with the ARB request which describes all measurements and planting positions. This must be drawn showing all relevant positioning with regard to the house and property lines.
- * Drawings can be hand drawn. They do not need to be to scale as long as measurements are shown. Make them large enough and dark enough to easily see.
- * All plantings must be in an approved mulched bed which is properly edged (to facilitate grass cutting). No plantings are allowed in the grass.
- * Front beds, in general, for most locations, may not be enlarged.
- * Once the owner creates the beds, they must maintain mulch and weed free beds.
- * The homeowner is responsible for specifying the **EXACT** type of shrub, tree, or flower by specific name.
- * The homeowner must specify the mature heights and widths of plantings. This may be determined from the internet, garden centers, landscapers, or labels on the plants.
- * It is important to remember the location of **trees** with respect to house structures, walks, bed edges, and property lines is of utmost importance. Nothing is allowed to grow across the property line onto a neighbor's property or HOA property. Mature tree heights and widths will be looked at closely.
- * "Walls" of trees preventing other residents sight lines will not be approved.
- * All shrubs, plants and flowers must fit within the bed at a reasonable mature size.
- * Refer to Section 3 of the Rules and Regulations for other specific information and Appendix A for the "Prohibited Plant List".
- * Photos of the areas to be planted are very helpful and lend perspective.
- * If you are replacing like trees, shrubs or flowers with like plants of the same kind, you do not need to send in a request. If several plants or shrubs have died and you are replacing them, you do not need to send in a request.

The following pages are just one example of the kind of information necessary for the ARB to understand and review a particular request. The measurements you take and the information on the plants you choose should tell you what will likely fit.

SAMPLE PLANTING IN TWO SMALL BEDS IN FRONT OF HOME

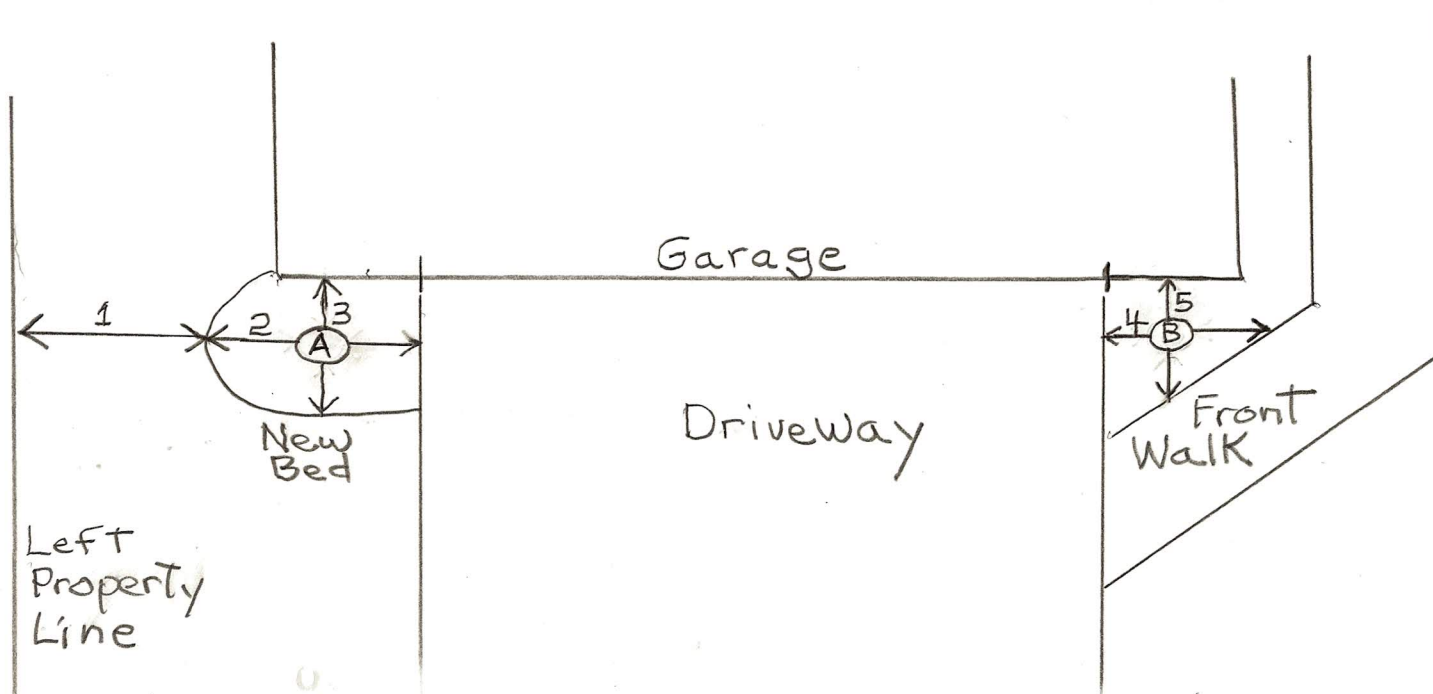

Left of garage:

1 distance from bed to property line

2 width of bed

3 depth of bed

Right of garage:

4 width of bed

5 depth of bed

This helps us see the location of new plantings "A" and "B". The measurements tell us if it will fit.

"A" – exact, specific name of plant, shrub, or tree H = (mature height) W = (mature width)

"B" – exact, specific name of plant, shrub, or tree H = (mature height) W = (mature width)

SAMPLE PLANTING IN A MAIN FRONT BED

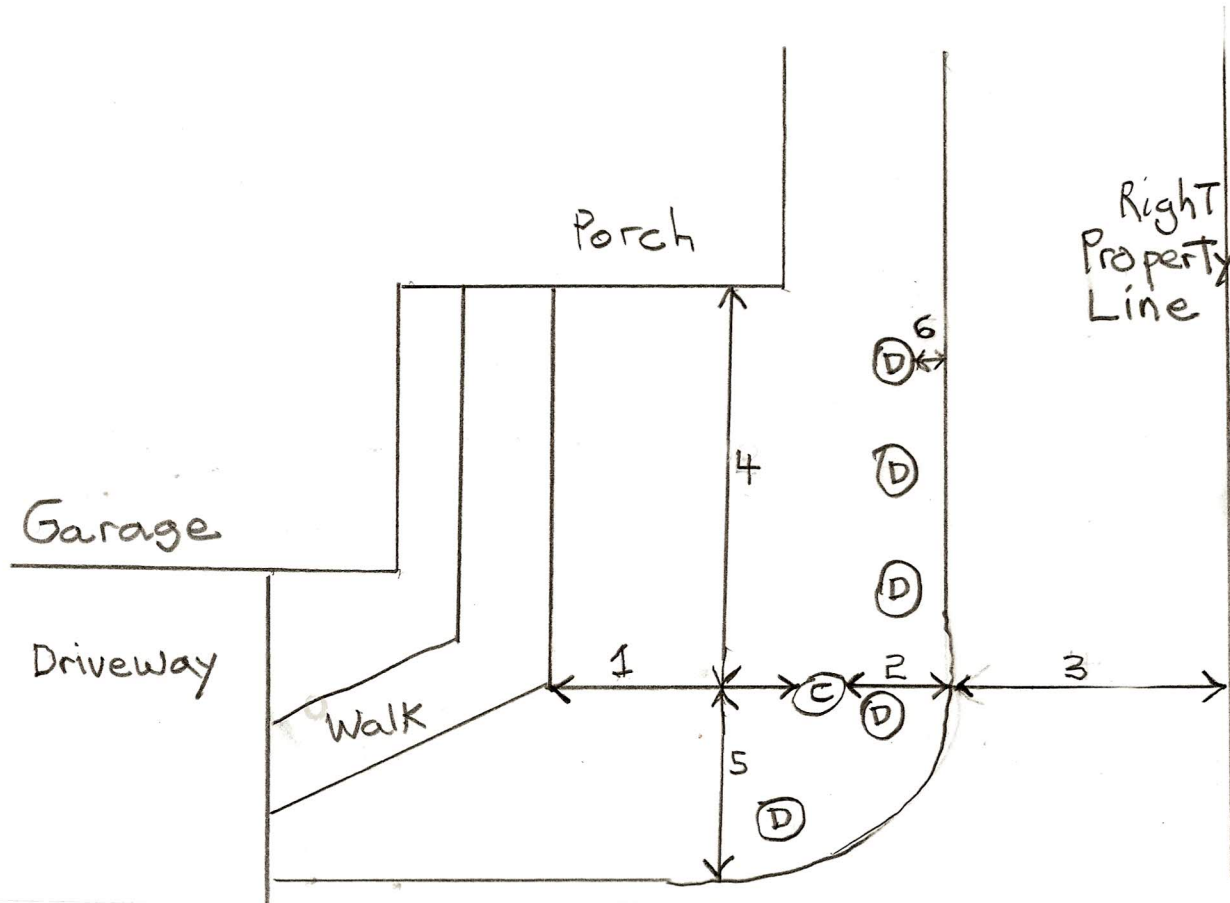

When planting a tree, the location is very important:

- 1 distance from walk to tree
- 2 distance from tree to edge of bed
- 3 distance from bed to property line (2 + 3 tells us if tree will overgrow property line)
- 4 distance from house to tree
- 5 distance from tree to front of bed

When planting shrubs we are generally concerned with overgrowing the edge of bed:

- 6 distance from shrub location to edge of bed

"C" – exact, specific name of plant, shrub, or tree H = (mature height) W = (mature width)
 "D" – exact, specific name of plant, shrub, or tree H = (mature height) W = (mature width)

SAMPLE PLANTING AROUND PATIO

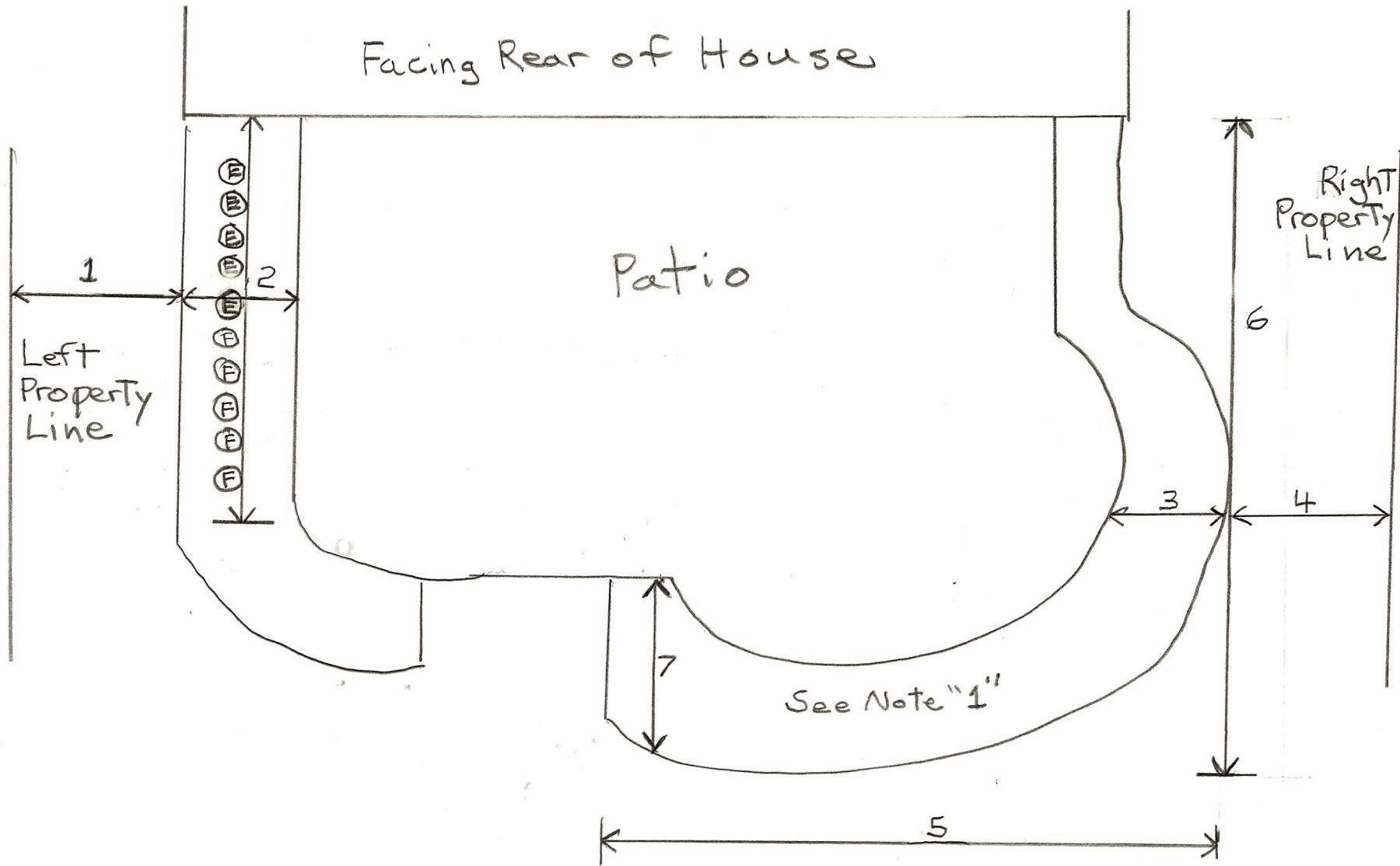

See Next Page for Key to This Drawing

KEYS TO SAMPLE PLANTING AROUND PATIO

- 1 – distance from bed edge to left property line
- 2 – width of bed on left side
- 3 – width of bed on right side
- 4 – distance from bed edge to right property line
- 5 – basic width across back of bed
- 6 – basic depth of bed from back side to house
- 7 – depth of wide end of bed

“E” – exact, specific name of plant, shrub, or tree H = (mature height) W = (mature width)

***** **Make a note here, for example, if these are existing.** *****

“F” - exact, specific name of plant, shrub, or tree H = (mature height) W = (mature width)

Note 1 – we are replacing some roses in this bed with new ones and we are replacing some hydrangeas which have died out in this bed with new ones. The position of these plants fit within spaces already previously planted. *(Authors note – if this is not the case, and the type of shrub selected for the empty spots is different, then the new items must be shown and requested in their locations on the drawing.)*